

# WORLEY'S

LIGHTING

## Palmetto Double Sconce

WS-PDS-107

### OVERVIEW

A wooden arm and artisan-made porcelain shades combine to create this versatile wall sconce. The Palmetto collection includes sconces, chandeliers and pendants featuring a beautiful mix of materials. Choose your wood, metal and porcelain finish to transform the overall look. Download Spec Sheet

Certifications	UL and cUL damp locations
Lamping	(2) E26, 60W, Bulb not included
Mounting	4", Universal
Lead Time	2-3 weeks
Dimensions	10" depth, 17" width, 8.5" height
As Shown	Cornsilk Oak, Classic Brass, Charcoal Porcelain



WORLEYSLIGHTING.COM  
TRADE@WORLEYSLIGHTING.COM

DIMENSIONS

Overall	10" depth, 17" width, 8.5" height
Canopy	5" diameter .75" depth
Shade	7" width, 5" height
Materials	Wood, brass or powder coated steel and aluminum, porcelain
Weight	7lbs
Origin	Made in USA of U.S. and imported parts

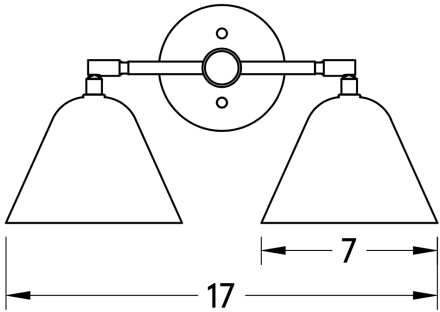
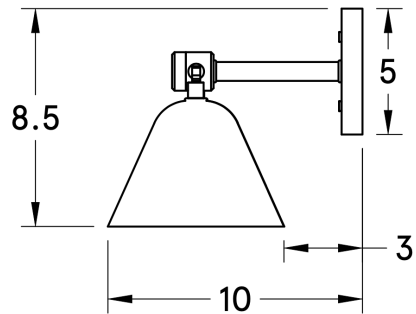

FINISHES

Our fixtures come in a variety of wood, metal, porcelain, linen and glass finishes. To discover what finishes are available for this fixture, click the link below or visit the product page on [worleyslighting.com](http://worleyslighting.com).

PALMETTO DOUBLE SCONCE FINISH OPTIONS

Finish samples are available at [worleyslighting.com/finishes](http://worleyslighting.com/finishes). For pricing and purchasing, please visit [worleyslighting.com](http://worleyslighting.com) or contact us with further questions.