

WORLEY'S

LIGHTING



Davidson Double Sconce

WS-DAVD-100

OVERVIEW

Featuring a charming mix of materials, this wall sconce will read well in any room. The handmade porcelain shades and unique wooden canopy make each sconce a true original.

Certifications	UL and cUL damp locations
Lamping	(2) E26, 550 Lumens, Bulbs included
Mounting	4", Universal
Lead Time	2-3 weeks
Dimensions	5.75" depth, 10.5" width, 11" height
Notes	Slight variations in opaqueness make each handmade shade unique.
As Shown	Cornsilk Oak, Classic Brass and White Porcelain

WORLEYSLIGHTING.COM
TRADE@WORLEYSLIGHTING.COM



DIMENSIONS

Overall	5.75" depth, 10.5" width, 11" height
Canopy	5" diameter .75" depth
Shade	3.5" Diameter
Clearance	2"
Materials	Wood, Brass or powder coated steel and aluminum, porcelain
Origin	Made in USA of U.S. and imported parts

FINISHES

Our fixtures come in a variety of wood, metal, porcelain, linen and glass finishes. To discover what finishes are available for this fixture, click the link below or visit the product page on worleyslighting.com.

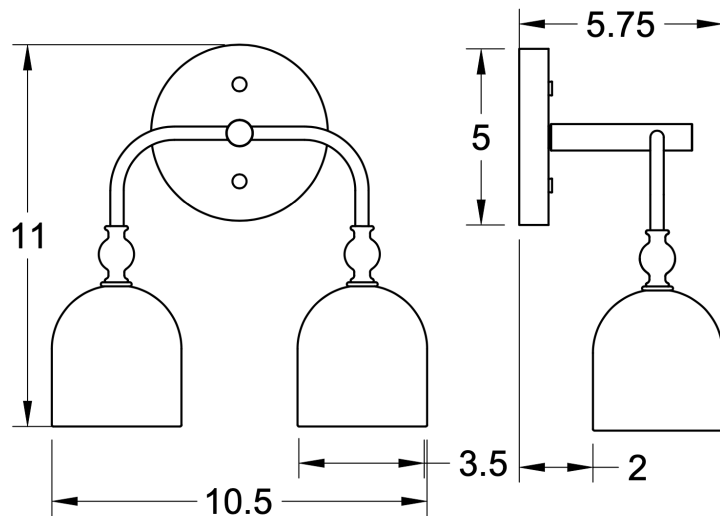

DAVIDSON DOUBLE SCONCE FINISH OPTIONS

Finish samples are available at worleyslighting.com/finishes. For pricing and purchasing, please visit worleyslighting.com or contact us with further questions.